

COPPER TUBE CRIMPING LUG TYPE AM
for copper conductors



Description:

- A-M series lugs are manufactured from electrolytic copper tube Cu-OF CW008A conform to UNI EN 13600:2003. The dimensions of the tube are designed to obtain the most efficient electrical conductivity and mechanical strength to resist vibration and pull out.
- Cembre lugs are annealed to guarantee optimum ductility which is an absolute necessity for connectors which will have to withstand the severe deformation arising when compressed and any bending of the palm during installation.
- In applications subject to vibration, terminals still have to perform a reliable connection, annealing plays a vital role in avoiding cracking or breaks between the barrel and palm.
- The presence of an inspection hole facilitates full insertion of the conductor, whilst the barrel length has been designed to allow easy and accurate positioning of the dies during the crimping operation.
- Lugs are electrolytically tin plated with a minimum thickness of 3µm to avoid oxidation. A-M series lugs form an important part of Cembre crimping systems for power carrying conductors.

• PROFESSIONAL MOTORSPORT WIRING

Each connector is marked as follows:

- Cembre trade mark and reference number.
- Nature and size of conductor (mm²).
- Ø stud (mm).

Markings:

 - According to UL 486A standard (file E125401)

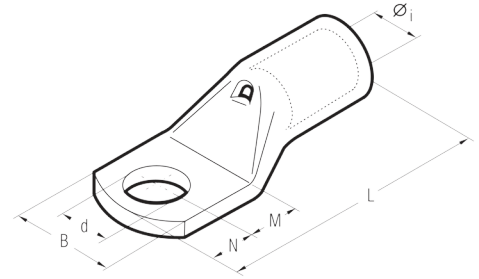

Cond. Size sqmm	Ø Stud mm	Ref.	Dimensions mm					
			Øi	B	M	N	L	d
0,25÷1,5	3	A 03-M 3*	1,8	6,0	4,5	3,5	16,0	3,2
	3,5	A 03-M 3,5*	1,8	6,5	4,5	3,5	16,0	3,7
	4	A 03-M 4*	1,8	6,5	5,0	4,0	17,0	4,3
	5	A 03-M 5*	1,8	7,5	5,5	4,5	18,0	5,3
	6	A 03-M 6*	1,8	9,0	6,0	5,0	19,0	6,4
1,5÷2,5	3	A 06-M 3*	2,4	6,0	4,5	3,5	17,0	3,2
	3,5	A 06-M 3,5*	2,4	6,5	4,5	3,5	17,0	3,7
	4	A 06-M 4*	2,4	7,5	5,0	4,0	18,0	4,3
	5	A 06-M 5*	2,4	8,5	5,5	4,5	19,0	5,3
	6	A 06-M 6*	2,4	9,0	6,0	5,0	20,0	6,4
	8	A 06-M 8*	2,4	12,0	9,0	8,0	26,0	8,4
4÷6	3	A 1-M 3	3,6	7,5	4,5	3,5	20,5	3,2
	3,5	A 1-M 3,5	3,6	7,5	4,5	3,5	20,5	3,7
	4	A 1-M 4	3,6	8,0	5,0	4,0	21,5	4,3
	5	A 1-M 5	3,6	9,0	6,5	6,0	25,0	5,3
	6	A 1-M 6	3,6	11,0	7,0	6,0	25,5	6,4
	8	A 1-M 8	3,6	14,0	9,0	8,0	29,5	8,4
10	10	A 1-M 10	3,6	16,5	11,0	10,0	33,5	10,5
	4	A 2-M 4	4,6	10,0	5,0	4,0	22,5	4,3
	5	A 2-M 5	4,6	10,0	6,5	6,0	26,0	5,3
	6	A 2-M 6	4,6	11,0	7,0	6,0	26,5	6,4
	8	A 2-M 8	4,6	15,0	9,0	8,0	30,5	8,4
	10	A 2-M 10	4,6	18,0	11,0	10,0	34,5	10,5
16	12	A 2-M 12	4,6	19,0	12,0	10,0	39,5	13,2
	4	A 3-M 4	5,8	11,5	5,0	4,0	25,5	4,3
	5	A 3-M 5	5,8	11,5	6,5	6,0	29,0	5,3
	6	A 3-M 6	5,8	11,5	7,0	6,0	29,5	6,4
	8	A 3-M 8	5,8	15,0	9,0	8,0	33,5	8,4
	10	A 3-M 10	5,8	18,0	11,0	10,0	37,5	10,5
25	12	A 3-M 12	5,8	20,0	14,0	12,0	42,5	13,2
	4	A 5-M 4	7,0	14,0	5,0	4,0	28,0	4,3
	5	A 5-M 5	7,0	14,0	6,5	6,0	31,5	5,3
	6	A 5-M 6	7,0	14,0	7,0	6,0	32,0	6,4
	8	A 5-M 8	7,0	15,0	9,0	8,0	36,0	8,4
	10	A 5-M 10	7,0	18,0	11,0	10,0	40,0	10,5
35	12	A 5-M 12	7,0	21,0	14,0	12,0	45,0	13,2
	5	A 7-M 5	8,9	17,0	6,5	6,0	34,0	5,3
	6	A 7-M 6	8,9	17,0	7,0	6,0	34,5	6,4
	8	A 7-M 8	8,9	17,0	9,0	8,0	38,5	8,4
	10	A 7-M 10	8,9	19,0	11,0	10,0	42,5	10,5
	12	A 7-M 12	8,9	21,0	14,0	12,0	47,5	13,2
50	6	A 10-M 6	10,0	19,0	8,0	7,0	38,5	6,4
	8	A 10-M 8	10,0	19,0	9,0	8,0	40,5	8,4
	10	A 10-M 10	10,0	20,0	11,5	9,5	44,5	10,5
	12	A 10-M 12	10,0	21,0	12,0	12,0	47,5	13,2
	14	A 10-M 14	10,0	25,0	16,0	14,0	55,5	15,0
	16	A 10-M 16	10,0	26,0	18,0	16,0	59,5	17,0
70	6	A 14-M 6	11,3	21,0	8,0	7,0	44,0	6,4
	8	A 14-M 8	11,3	21,0	9,0	8,0	46,0	8,4
	10	A 14-M 10	11,3	21,0	11,0	10,0	50,0	10,5
	12	A 14-M 12	11,3	22,0	14,0	12,0	55,0	13,2
	14	A 14-M 14	11,3	25,0	16,0	14,0	59,0	15,0
	16	A 14-M 16	11,3	26,0	18,0	16,0	63,0	17,0

Cond. Size sqmm	Ø Stud mm	Ref.	Dimensions mm						
			Øi	B	M	N	L	d	
95	6	A 19-M 6	13,5	25,0	8,0	7,0	50,5	6,4	
	8	A 19-M 8	13,5	25,0	9,0	8,0	52,5	8,4	
	10	A 19-M 10	13,5	25,0	11,0	10,0	56,5	10,5	
	12	A 19-M 12	13,5	25,0	14,0	12,0	61,5	13,2	
	14	A 19-M 14	13,5	25,0	16,0	14,0	65,5	15,0	
	16	A 19-M 16	13,5	27,0	18,0	16,0	69,5	17,0	
120	20	A 19-M 20	13,5	29,5	22,0	20,0	77,5	21,0	
	8	A 24-M 8	15,2	28,5	9,0	8,0	54,0	8,4	
	10	A 24-M 10	15,2	28,5	11,0	10,0	58,0	10,5	
	12	A 24-M 12	15,2	28,5	14,0	12,0	63,0	13,2	
	14	A 24-M 14	15,2	28,5	16,0	14,0	67,0	15,0	
	16	A 24-M 16	15,2	28,5	18,0	16,0	71,0	17,0	
150	20	A 24-M 20	15,2	30,0	22,0	20,0	79,0	21,0	
	8	A 30-M 8	16,7	31,5	13,0	11,0	69,0	8,4	
	10	A 30-M 10	16,7	31,5	13,0	11,0	69,0	10,5	
	12	A 30-M 12	16,7	31,5	16,0	14,0	75,0	13,2	
	14	A 30-M 14	16,7	31,5	18,0	16,0	79,0	15,0	
	16	A 30-M 16	16,7	31,5	19,0	17,0	81,0	17,0	
185	20	A 30-M 20	16,7	31,5	22,0	20,0	87,0	21,0	
	8	A 37-M 8	19,2	35,5	13,0	11,0	76,0	8,4	
	10	A 37-M 10	19,2	35,5	13,0	11,0	76,0	10,5	
	12	A 37-M 12	19,2	35,5	16,0	14,0	82,0	13,2	
	14	A 37-M 14	19,2	35,5	18,0	16,0	86,0	15,0	
	16	A 37-M 16	19,2	35,5	19,0	17,0	88,0	17,0	
240	20	A 37-M 20	19,2	35,5	22,0	20,0	94,0	21,0	
	8	A 48-M 8	21,1	39,0	13,0	11,0	77,5	8,4	
	10	A 48-M 10	21,1	39,0	13,0	11,0	77,5	10,5	
	12	A 48-M 12	21,1	39,0	14,0	12,0	79,5	13,2	
	14	A 48-M 14	21,1	39,0	18,0	16,0	92,0	15,0	
	16	A 48-M 16	21,1	39,0	19,0	17,0	94,0	17,0	
300	20	A 48-M 20	21,1	39,0	22,0	20,0	100,0	21,0	
	10	A 60-M 10	23,7	44,0	20,0	11,0	96,0	10,5	
	12	A 60-M 12	23,7	44,0	20,0	14,0	99,0	13,2	
	14	A 60-M 14	23,7	44,0	22,0	16,0	103,0	15,0	
	16	A 60-M 16	23,7	44,0	22,0	19,0	106,0	17,0	
	20	A 60-M 20	23,7	44,0	24,0	23,0	112,0	21,0	
400	12	A 80-M 12	27,0	51,0	22,0	19,0	113,0	13,2	
	14	A 80-M 14	27,0	51,0	22,0	19,0	113,0	15,0	
	16	A 80-M 16	27,0	51,0	22,0	19,0	113,0	17,0	
	20	A 80-M 20	27,0	51,0	24,0	23,0	119,0	21,0	
	16	A 100-M 16	30,3	56,5	22,0	19,0	117,0	17,0	
	20	A 100-M 20	30,3	56,5	24,0	23,0	123,0	21,0	
630	500	16	A 120-M 16*	33,4	61,6	22,0	19,0	128,0	17,0
	630	20	A 120-M 20*	33,4	61,6	24,0	23,0	134,0	21,0
800	630	16	A 160-M 16*	38,0	72,0	24,0	19,0	141,0	17,0
	630	20	A 160-M 20*	38,0	72,0	24,0	23,0	145,0	21,0
1000	800	16	A 200-M 16*	44,0	80,0	24,0	19,0	158,0	17,0
	800	20	A 200-M 20*	44,0	80,0	24,0	23,0	162,0	21,0

*Actual conductor section may require a larger lug eg for 120 mm² size use A30-... lug.

*Not UL approved